

CITY OF KELOWNA

BYLAW NO. 9430

**Z04-0075 – Kirschner Mountain Estates Ltd.; Allan Kirschner;
Angelica Kirschner; Gordon Kirschner; Heidi-Sabine Kirschner;
Donald Kirschner; Amy Kirschner-(New Town Planning Services Inc.)
2980 Gallagher Road, 2045 & 2061 Garner Road & 1625 Verdure Road**

A bylaw to amend the "City of Kelowna Zoning Bylaw No. 8000".

The Municipal Council of the City of Kelowna, in open meeting assembled, enacts as follows:

1. THAT City of Kelowna Zoning Bylaw No. 8000 be amended by changing the zoning classification of part of Lot 1, Sections 12 & 13, Twp. 26 and Sections 7 & 18, Twp. 27, ODYD, Plan KAP71697, located on 2980 Gallagher Road; Part of Lot A, Section 13, Twp. 26, ODYD, Plan KAP48770 except Plans KAP75167 and KAP76806, located on 2045 Garner Road; Lot D, Section 13, Twp. 26, ODYD, Plan KAP48770, located on 2061 Garner Road; and Lot 3, Section 13, Twp. 26 and of Section 18, Twp. 27, ODYD, Plan KAP44995 except Plan KAP76806 located on 1625 Verdure Road, Kelowna, B.C., from the A1 – Agriculture 1 zone to the P3 – Parks & Open Space, RU1h – Large Lot Housing (Hillside Area) and RM3h – Low Density Multiple Housing (Hillside Area) zones as per Map “B” attached.
2. This bylaw shall come into full force and effect and is binding on all persons as and from the date of adoption.

Read a first time by the Municipal Council this 12th day of December, 2005.

Considered at a Public Hearing on the 10th day of January, 2005.

Read a second and third time by the Municipal Council this

Approved under The Transportation Act this

(Approving Officer - Ministry of Transportation)

Adopted by the Municipal Council of the City of Kelowna this

Mayor

City Clerk

MAP "B"

PROPOSED REZONING FROM A1 – AGRICULTURE 1
TO:

- RU1h = LARGE LOT HOUSING (HILLSIDE AREA)
- RM3h = LOW DENSITY MULTIPLE HOUSING (HILLSIDE AREA)
- P3 = PARKS & OPEN SPACE

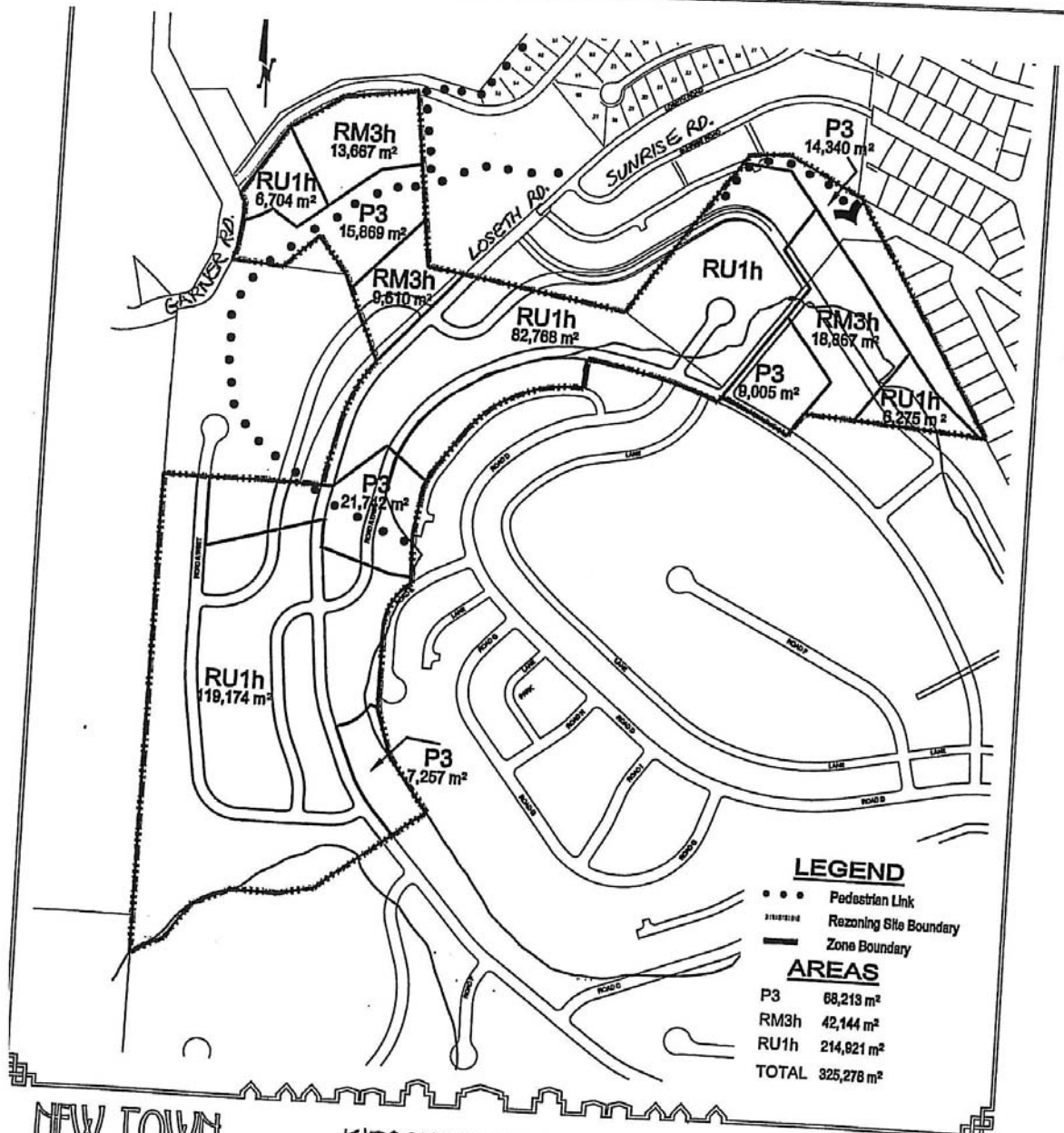

NEW TOWN
PLANNING SERVICES

KIRSCHNER MOUNTAIN
PHASE II

PROJECT No. 1251
DRAWN BY: WJZ/RBM
DATE: 11/11/03